

**Studio 18**  
 Stage 18  
 Baufäche 54,00 x 16,00m  
 Construction Area 177.16 x 53.48ft  
 Bauhöhe 7,50 / 9,10m  
 Construction Height 24.60 / 29.85ft  
 max. Bodenbelastung 1000kg/m<sup>2</sup>  
 max. Floor Load Capacity 200lb/ft<sup>2</sup>

**Kontakt / Contact:**  
 Studio Babelsberg AG  
 Studio- und Atelierbetrieb  
 Stage Rental  
 August-Bebel-Straße 26-53  
 14482 Potsdam  
 +49 (0) 331 / 721 21 06  
 StageRental@studiobabelsberg.com  
 www.studiobabelsberg.com

Studiofläche ges. 1975m<sup>2</sup>  
 Total Area 21248ft<sup>2</sup>  
 Baufäche 54,00 x 16,00m  
 Total Area 177.16 x 52.48ft  
 Bauhöhe 7,50 / 9,10m  
 Construction Height 24.60 / 29.85ft  
 max. Bodenbelastung 1000kg/m<sup>2</sup>  
 max. Floor Load Capacity 200lb/ft<sup>2</sup>  
 Alle Maße sind vor Ort zu prüfen.  
 All measurements are to be checked on site.

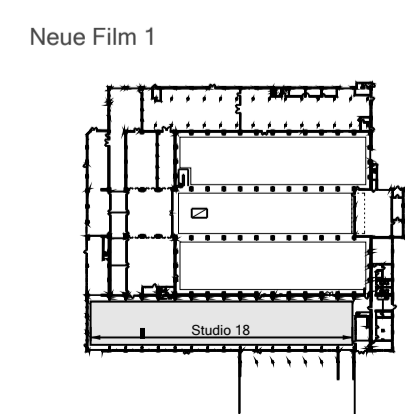

**STUDIO BABELSBERG**  
 Neue Film 1  
**Studio 18**  
 Stage 18  
 Grundriss M 1:200 @ A2  
 Floor Plan 1:200